

**Recommended Run Times (minutes)**

- Spray – Shrub 12
- Spray – Lawn 25
- Rotor – Lawn 45
- Drip – Lawn 45

**Recommended Monthly Cycles**

- (Water Days)
- January 3
  - February 3
  - March 4
  - April 4
  - May 7
  - June 9
  - July 11
  - August 11
  - September 9
  - October 6
  - November 4
  - December 3

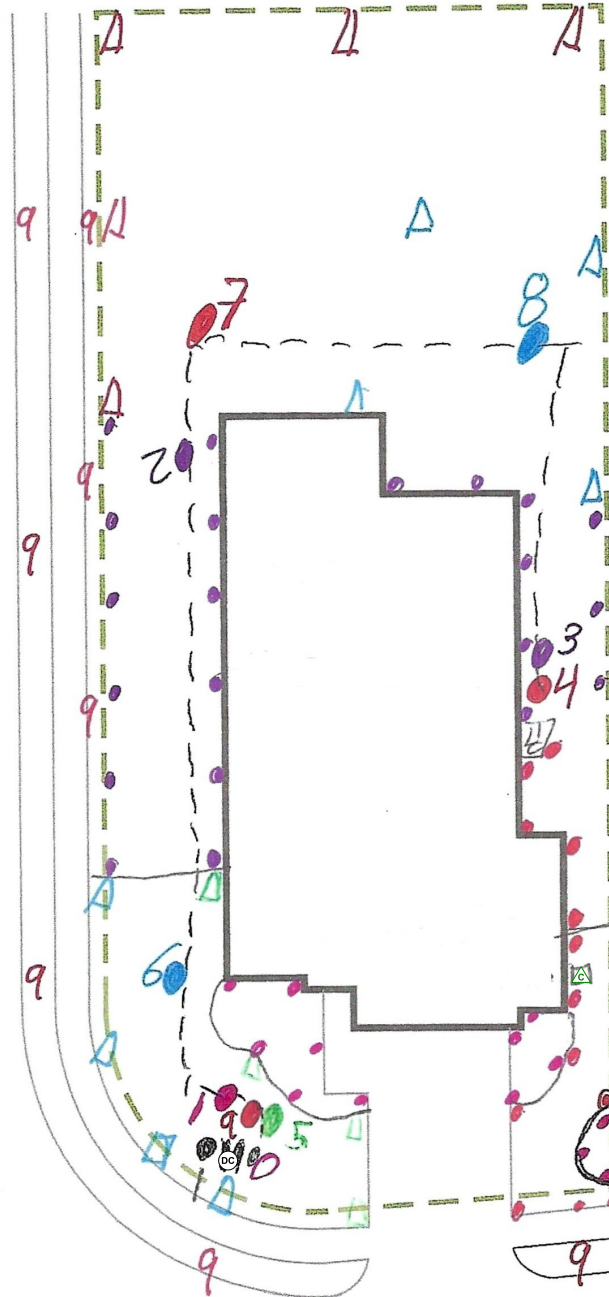
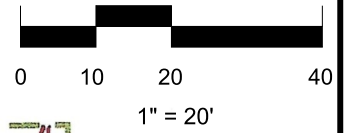

**Recommended Maintenance**

- Backflow – Test Annually
- Filter – Check Annually for debris
- Heads – Run system monthly checking for leaks or broken heads
- Valve Covers – Trim grass to keep exposed
- Controller – Seasonal update programming
- Winter – Run system briefly every 2 weeks if system turned off

**Legend**

- ⊙ Backflow
- ⊗ Control Valve
- ▣ Spray - Shrub
- Spray - Lawn
- ▼ Rotor - Lawn
- ▭ Drip Tubing
- - - Main Line

**COMPLETION ITEMS PROVIDED**

- The manufacturer's manual for the controller.
- A seasonal watering schedule.
- A list of components that require maintenance and the recommended frequency of maintenance.
- A permanent sticker has been attached to the controller indicating the warranty period for the irrigation system and contact information.
- The corrected or re-drawn design plans indicating the actual installation and components of the system.
- Location and operation of the isolation valve.

**6517 DRAGRIDE ROAD**

This irrigation system has been installed in accordance with all applicable state and local laws, ordinances, rules, regulations or orders. I have tested the system and determined that it has been installed according to the irrigation plan and is properly adjusted for the most efficient application of water at this time.

\_\_\_\_\_  
System Owner / Representative Date



*J*

7.15.2024

**NOTE: ALL Piping shown is diagrammatic and NOT illustrating actual location.**

|  |   |  |  |
|--|---|--|--|
| <p><b>SHEET:</b><br/>1 of 1</p> <p><b>SCALE:</b><br/>1" = 20'</p> <p><b>CHECKED BY:</b><br/>STUBBLEFIELD</p> <p><b>DRAWN BY:</b><br/>CARTER</p> <p><b>JOB NUMBER:</b><br/>78610DRAG517</p> <p><b>DATE:</b><br/>7.15.2024</p> | <p><b>PROJECT:</b><br/>6517 DRAGRIDE ROAD<br/>BUDA, TX 78610</p> <p>LOT 17 BLOCK F<br/>TURNERS CROSSING NORTH</p> | <p><b>SHEET DESCRIPTION:</b><br/>IRRIGATION PLAN</p> <div style="text-align: center;"> <p>NORTH</p> </div> | <p><b>COMPANY:</b><br/>BEST OF TEXAS LANDSCAPES<br/>LIBERTY HILL, TEXAS 78642<br/>(512) 260-1430<br/>www.bestoftexaslandscapes.com</p> |
|--|---|--|--|