

**Recommended Run Times (minutes)**

- Spray – Shrub 12
- Spray – Lawn 25
- Rotor – Lawn 45
- Drip – Lawn 45

**Recommended Monthly Cycles**

(Water Days)

- January 3
- February 3
- March 4
- April 4
- May 7
- June 9
- July 11
- August 11
- September 9
- October 6
- November 4
- December 3

**Recommended Maintenance**

- Backflow – Test Annually
- Filter – Check Annually for debris
- Heads – Run system monthly checking for leaks or broken heads
- Valve Covers – Trim grass to keep exposed
- Controller – Seasonal update programming
- Winter – Run system briefly every 2 weeks if system turned off

**Legend**

- ⊗ Backflow
- △ Controller
- ⊗ Control Valve
- Spray - Shrub
- Spray - Lawn
- ▽ Rotor - Lawn
- B Bubbler
- Drip Tubing
- - - Main Line

**COMPLETION ITEMS PROVIDED**

- The manufacturer's manual for the controller.
- A seasonal watering schedule.
- A list of components that require maintenance and the recommended frequency of maintenance.
- A permanent sticker has been attached to the controller indicating the warranty period for the irrigation system and contact information.
- The corrected or re-drawn design plans indicating the actual installation and components of the system.
- Location and operation of the isolation valve.

This irrigation system has been installed in accordance with all applicable state and local laws, ordinances, rules, regulations or orders. I have tested the system and determined that it has been installed according to the irrigation plan and is properly adjusted for the most efficient application of water at this time.

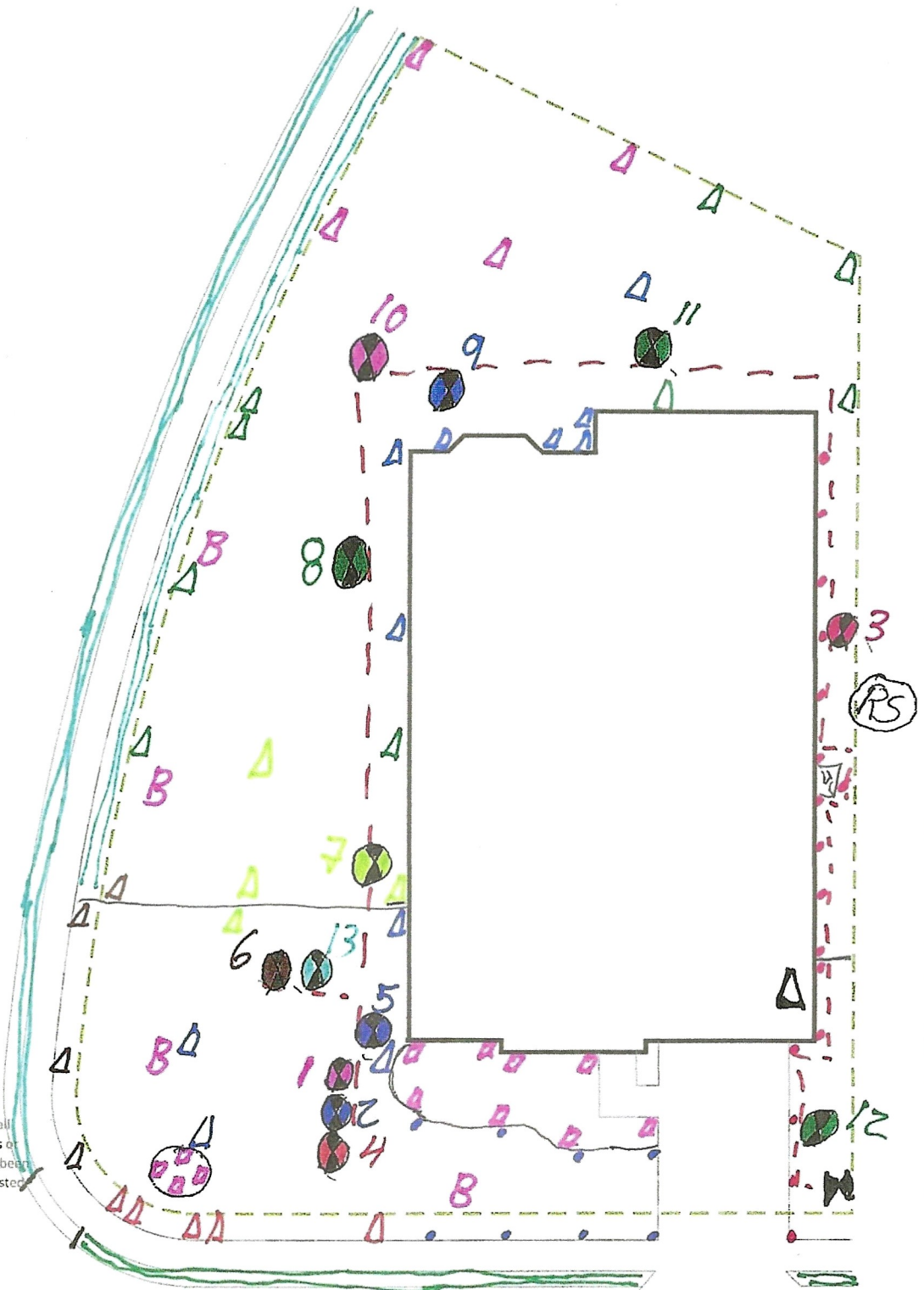

## 239 NAUTICAL LOOP

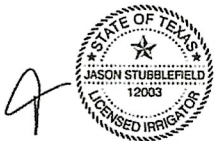

10.23.2024

NOTE: ALL Piping shown is diagrammatic and NOT illustrating actual location.

SHEET 1 of 1	SCALE: 1" = 20'	CHECKED BY: STUBBLERFELD	DRAWN BY: CARTER	JOB NUMBER: 78634NAU239	DATE: 10.23.2024	PROJECT:	SHEET DESCRIPTION:	COMPANY:
						239 NAUTICAL LOOP KYLE, TX 78634	IRRIGATION PLAN	BEST OF TEXAS LANDSCAPES LIBERTY HILL, TEXAS 78642  (512) 260-1430  <a href="http://www.bestoftexaslandscapes.com">www.bestoftexaslandscapes.com</a>