

**Recommended Run Times (minutes)**

- Spray – Shrub 12
- Spray – Lawn 25
- Rotor – Lawn 45
- Drip – Lawn 45



**Recommended Monthly Cycles**

(Water Days)

- January 3
- February 3
- March 4
- April 4
- May 7
- June 9
- July 11
- August 11
- September 9
- October 6
- November 4
- December 3

**Recommended Maintenance**

- Backflow – Test Annually
- Filter – Check Annually for debris
- Heads – Run system monthly checking for leaks or broken heads
- Valve Covers – Trim grass to keep exposed
- Controller – Seasonal update programming
- Winter – Run system briefly every 2 weeks if system turned off

**Legend**

- ⊙ Backflow
- ⊗ Control Valve
- Spray - Shrub
- Spray - Lawn
- ▼ Rotor - Lawn
- Drip Tubing
- - - Main Line

**COMPLETION ITEMS PROVIDED**

- The manufacturer’s manual for the controller.
- A seasonal watering schedule.
- A list of components that require maintenance and the recommended frequency of maintenance.
- A permanent sticker has been attached to the controller indicating the warranty period for the irrigation system and contact information.
- The corrected or re-drawn design plans indicating the actual installation and components of the system.
- Location and operation of the isolation valve.

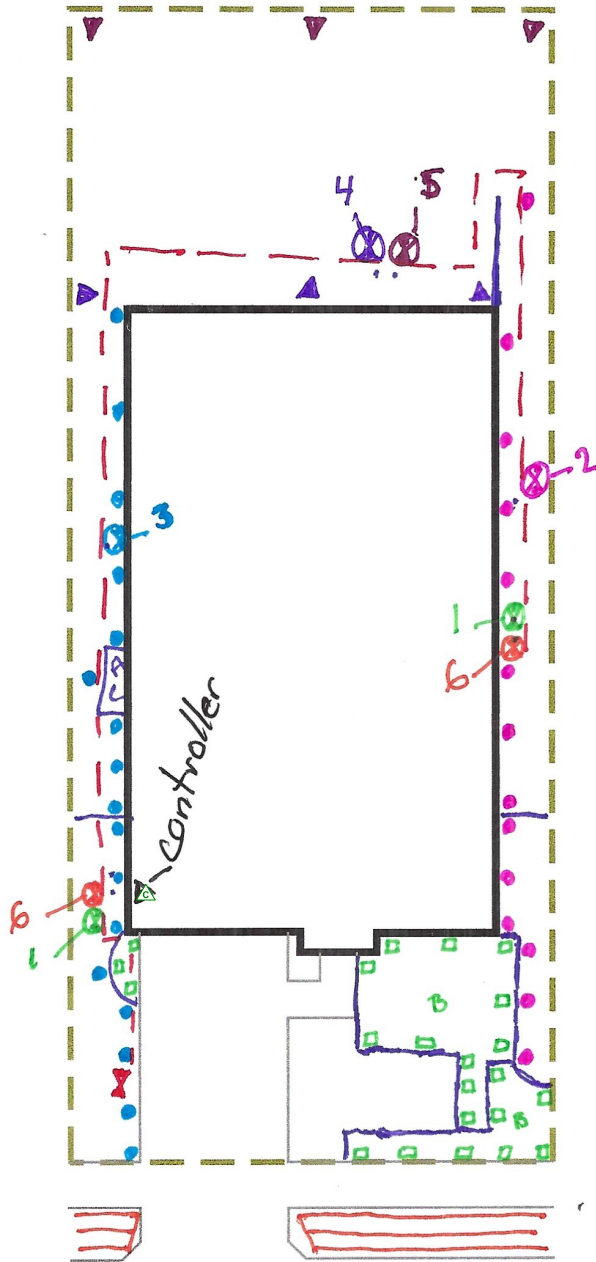

**1413 COLE ESTATES DRIVE**

This irrigation system has been installed in accordance with all applicable state and local laws, ordinances, rules, regulations or orders. I have tested the system and determined that it has been installed according to the irrigation plan and is properly adjusted for the most efficient application of water at this time.

\_\_\_\_\_  
System Owner / Representative Date

*[Signature]*

8.12.2024

**NOTE: ALL Piping shown is diagrammatic and NOT illustrating actual location.**



|                  |                    |                             |                           |                    |                             |   |                                       |  |
|------------------|--------------------|-----------------------------|---------------------------|--------------------|-----------------------------|---|---------------------------------------|--|
| SHEET:<br>1 of 1 | SCALE:<br>1" = 20' | CHECKED BY:<br>STUBBLEFIELD | DRAWN BY:<br>STUBBLEFIELD | DATE:<br>8-12-2024 | JOB NUMBER:<br>78298COL1413 | PROJECT:<br>1413 COLE ESTATES DRIVE<br>GEORGETOWN, TX 78628 | SHEET DESCRIPTION:<br>IRRIGATION PLAN | COMPANY:<br>BEST OF TEXAS LANDSCAPES<br>LIBERTY HILL, TEXAS 78642<br>(512) 260-1430<br>www.bestoftexaslandscapes.com |
|                  |                    |                             |                           |                    |                             |   |                                       |  |