

**Recommended Run Times (minutes)**

- Spray – Shrub 12
- Spray – Lawn 25
- Rotor – Lawn 45



**Recommended Monthly Cycles**

- (Water Days)
- January 3
  - February 3
  - March 4
  - April 4
  - May 7
  - June 9
  - July 11
  - August 11
  - September 9
  - October 6
  - November 4
  - December 3

**Recommended Maintenance**

- Backflow – Test Annually (contact Lewis Sinclair 512-563-8762)
- Filter – Check Annually for debris
- Heads – Run system monthly checking for leaks or broken heads
- Valve Covers – Trim grass to keep exposed
- Controller – Seasonal update programming
- Winter – Run system briefly every 2 weeks if system turned off

**Legend**

- Ⓢ Backflow
- ⊗ Control Valve
- Spray - Shrub
- Spray - Lawn
- ▼ Rotor - Lawn
- ▭ Drip Tubing
- - - Main Line

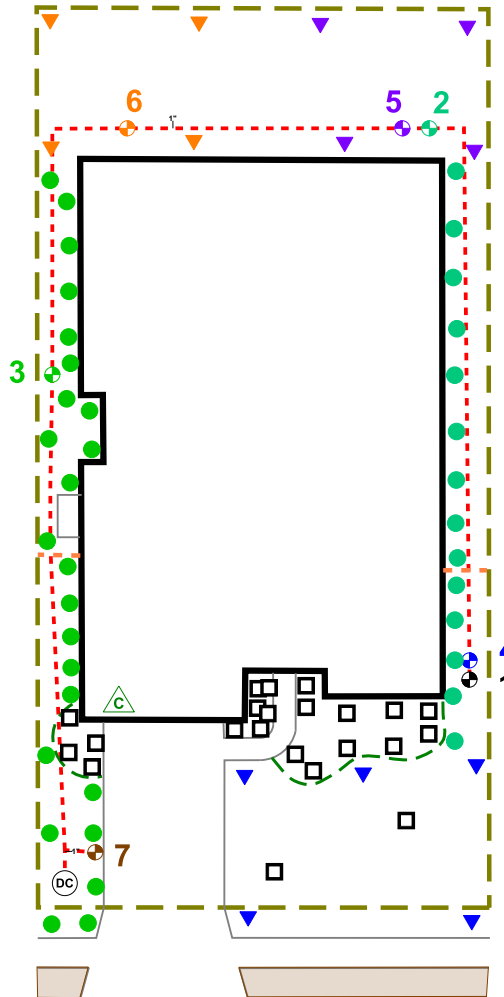

**COMPLETION ITEMS PROVIDED**

- The manufacturer’s manual for the controller.
- A seasonal watering schedule.
- A list of components that require maintenance and the recommended frequency of maintenance.
- A permanent sticker has been attached to the controller indicating the warranty period for the irrigation system and contact information.
- The corrected or re-drawn design plans indicating the actual installation and components of the system.
- Location and operation of the isolation valve.

**21104 BROOKLYNN MELISSA DRIVE**



*[Signature]*

08/29/21

This irrigation system has been installed in accordance with all applicable state and local laws, ordinances, rules, regulations or orders. I have tested the system and determined that it has been installed according to the irrigation plan and is properly adjusted for the most efficient application of water at this time.

\_\_\_\_\_  
System Owner / Representative

\_\_\_\_\_  
Date

**NOTE: ALL Piping shown is diagrammatic and NOT illustrating actual location.**

<p><b>DATE:</b> 2021 - 08 / 29</p> <p><b>JOB NUMBER:</b> 78660-BRO-21104</p> <p><b>DRAWN BY:</b> SINCLAIR</p> <p><b>CHECKED BY:</b> STUBBLEFIELD</p> <p><b>SCALE:</b> 1" = 20'</p> <p><b>SHEET:</b> 1 of 1</p>	<p><b>REVISIONS:</b></p> <p>COMPLETION: 09/21/21</p>	<p><b>PROJECT:</b></p> <p>21104 BROOKLYNN MELISSA DRIVE PFLUGERVILLE, TX 78660</p> <p>LOT 11, BLOCK BB THE PARK AT BLACKHAWK IV PHASE 1</p>	<p><b>SHEET DESCRIPTION:</b></p> <p>IRRIGATION PLAN</p>	<p><b>COMPANY:</b></p> <p>BEST OF TEXAS LANDSCAPES LIBERTY HILL, TEXAS 78642</p> <p>(512) 260-1430</p> <p>www.bestoftexaslandscapes.com</p>
--	--	---	---	---