

System Owner / Representative _____

Date _____

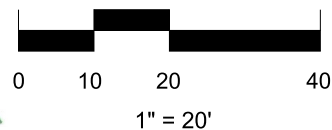

This irrigation system has been installed in accordance with all applicable state and local laws, ordinances, rules, regulations or orders. I have tested the system and determined that it has been installed according to the irrigation plan and is properly adjusted for the most efficient application of water at this time.

Recommended Maintenance

- Backflow – Test Annually (contact Lewis Sinclair 512-563-8762)
- Filter – Check Annually for debris
- Heads – Run system monthly checking for leaks or broken heads
- Valve Covers – Trim grass to keep exposed
- Controller – Seasonal update programming
- Winter – Run system briefly every 2 weeks if system turned off

COMPLETION ITEMS PROVIDED

- The manufacturer’s manual for the controller.
- A seasonal watering schedule.
- A list of components that require maintenance and the recommended frequency of maintenance.
- A permanent sticker has been attached to the controller indicating the warranty period for the irrigation system and contact information.
- The corrected or re-drawn design plans indicating the actual installation and components of the system.
- Location and operation of the isolation valve.

Recommended Run Times (minutes)

- Spray – Shrub 12
- Spray – Lawn 25
- Rotor – Lawn 45

Legend

- Ⓢ Backflow
- ⊗ Control Valve
- Spray - Shrub
- Spray - Lawn
- ▼ Rotor - Lawn
- Drip Tubing
- - - Main Line

Recommended Monthly Cycles

(Water Days)

- January 3
- February 3
- March 4
- April 4
- May 7
- June 9
- July 11
- August 11
- September 9
- October 6
- November 4
- December 3

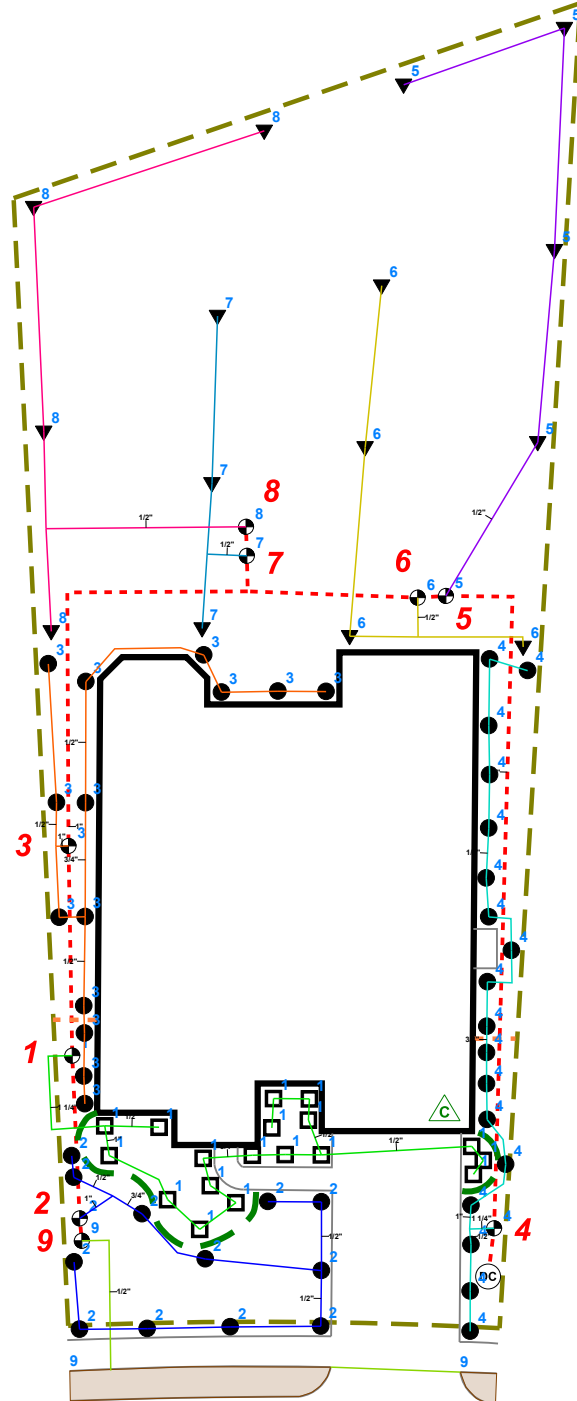

3016 SHANE DRIVE

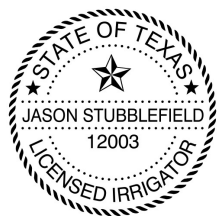

06/18/19

DATE:	2019 - 06 / 19
JOB NUMBER:	78641-SHA-3016
DRAWN BY:	SINCLAIR
CHECKED BY:	STUBBLEFIELD
SCALE:	1" = 20'
SHEET:	1 of 1

REVISIONS:	
COMPLETION:	06/18/19

PROJECT:	3016 SHANE DRIVE LEANDER, TX 78641
	LOT 19, BLOCK X BLUFFS AT CRYSTAL FALLS

SHEET DESCRIPTION:	IRRIGATION PLAN

COMPANY:	BEST OF TEXAS LANDSCAPES LIBERTY HILL, TEXAS 78642
	(512) 260-1430
	www.bestoftexaslandscapes.com