

Best of Texas

Landscapes

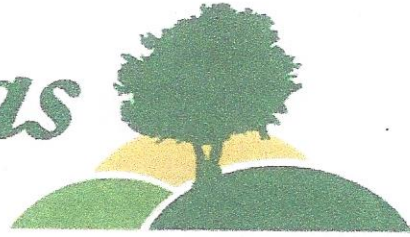

Maintenance Check List

Installation Completion Date: 8-2-2013

Address: 210 Mia Drive

The following items have been provided and explained to the irrigation system owner or system owner's representative.

- The manufacturer's manual for the controller.
- A seasonal watering schedule.
- A list of components that require maintenance and the recommended frequency of maintenance is attached
- A permanent sticker has been attached to the controller indicating the warranty period for the irrigation system and contact information.
- The corrected or re-drawn design plans indicating the actual installation and components of the system.
- Location and operation of the isolation valve.

Irrigation system owner/representative

Date

This irrigation system has been installed in accordance with all applicable state and local laws, ordinances, rules, regulations or orders. I have tested the system and determined that it has been installed according to the irrigation plan and is properly adjusted for the most efficient application of water at this time.

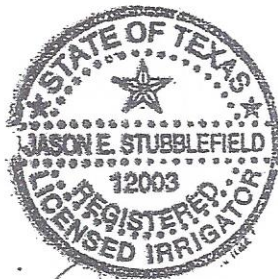

[Signature]
Irrigator/Date

Irrigation Technician/ Date

Irrigation

| Qty | Symbol | Description | Part Number | Pressure | Flow | Radius |
|-----|--------|--------------------------------------|-------------|----------|----------|--------|
| 3 | ● | Rain Bird 10F - 1804 | 10F | 30 psi | 1.58 gpm | 10 ft |
| 45 | ● | Rain Bird 10H - 1804 | 10H | 30 psi | 0.79 gpm | 10 ft |
| 14 | ● | Rain Bird 10Q - 1804 | 10Q | 30 psi | 0.39 gpm | 10 ft |
| 5 | ● | Rain Bird 10T - 1804 | 10T | 30 psi | 0.53 gpm | 10 ft |
| 4 | ○ | Rain Bird 1404 | 1404 | 30 psi | 1 gpm | 0 ft |
| 2 | ● | Rain Bird 5000-MPR-25-F - 5004-PL-FC | MPR-25-F | 45 psi | 3.82 gpm | 25 ft |
| 8 | ● | Rain Bird 5000-MPR-25-H - 5004-PL-PC | MPR-25-H | 45 psi | 1.98 gpm | 25 ft |
| 10 | ● | Rain Bird 5000-MPR-25-Q - 5004-PL-PC | MPR-25-Q | 45 psi | 1 gpm | 25 ft |
| 33 | ● | Rain Bird 8H - 1804 | 8H | 30 psi | 0.52 gpm | 8 ft |
| 25 | ● | Rain Bird 8Q - 1804 | 8Q | 30 psi | 0.26 gpm | 8 ft |
| 1 | ● | Rain Bird 8T - 1804 | 8T | 30 psi | 0.35 gpm | 8 ft |

| Water Source #1 | |
|----------------------------|--------------------|
| Meter Size | 5/8 inch meter |
| Static Pressure | 30 psi |
| Elevation Change | 0 ft |
| Service Line Information | |
| Pipe Category | Schedule 40 PVC |
| Pipe Size | Schedule 40 1 1/4" |
| Length | 5 ft |
| Velocity | 5 fps |
| Recommendations | |
| Maximum Recommended Flow | 12 gpm |
| Available Working Pressure | 53.96 psi |

| Water Source | |
|------------------------|------------------------------|
| 1 | 5/8 inch meter |
| Backflow Devices | |
| 1 | Conbraco 40-105-T2 40-105-T2 |
| Control Valves | |
| 13 | Rain Bird 100-DVF 100-DVF |
| Y-Strainers / Filters | |
| 1 | Febco 650A-1" 4305 |
| Irrigation Accessories | |
| 1 | Nelson 9501-100IN 9501-100IN |
| 1 | Rain Bird ESP-4M ESP-4M |
| 1 | Rain Bird RSD-BEx RSD-BEx |
| Lateral Line Pipe | |
| 1159.08 ft | Schedule 40 1/2" |
| 130.66 ft | Schedule 40 3/4" |
| 208.73 ft | Schedule 40 1" |
| Mainline Pipe | |
| 237.29 ft | Schedule 40 1" |

210 Mia Drive
Design pressure all zones - 65psi

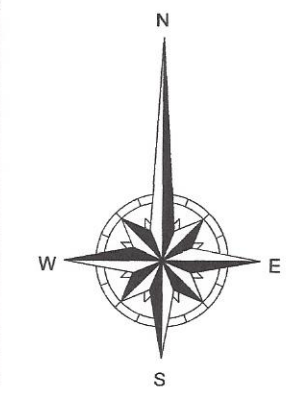

Jason Stubblefield
8/20/2013

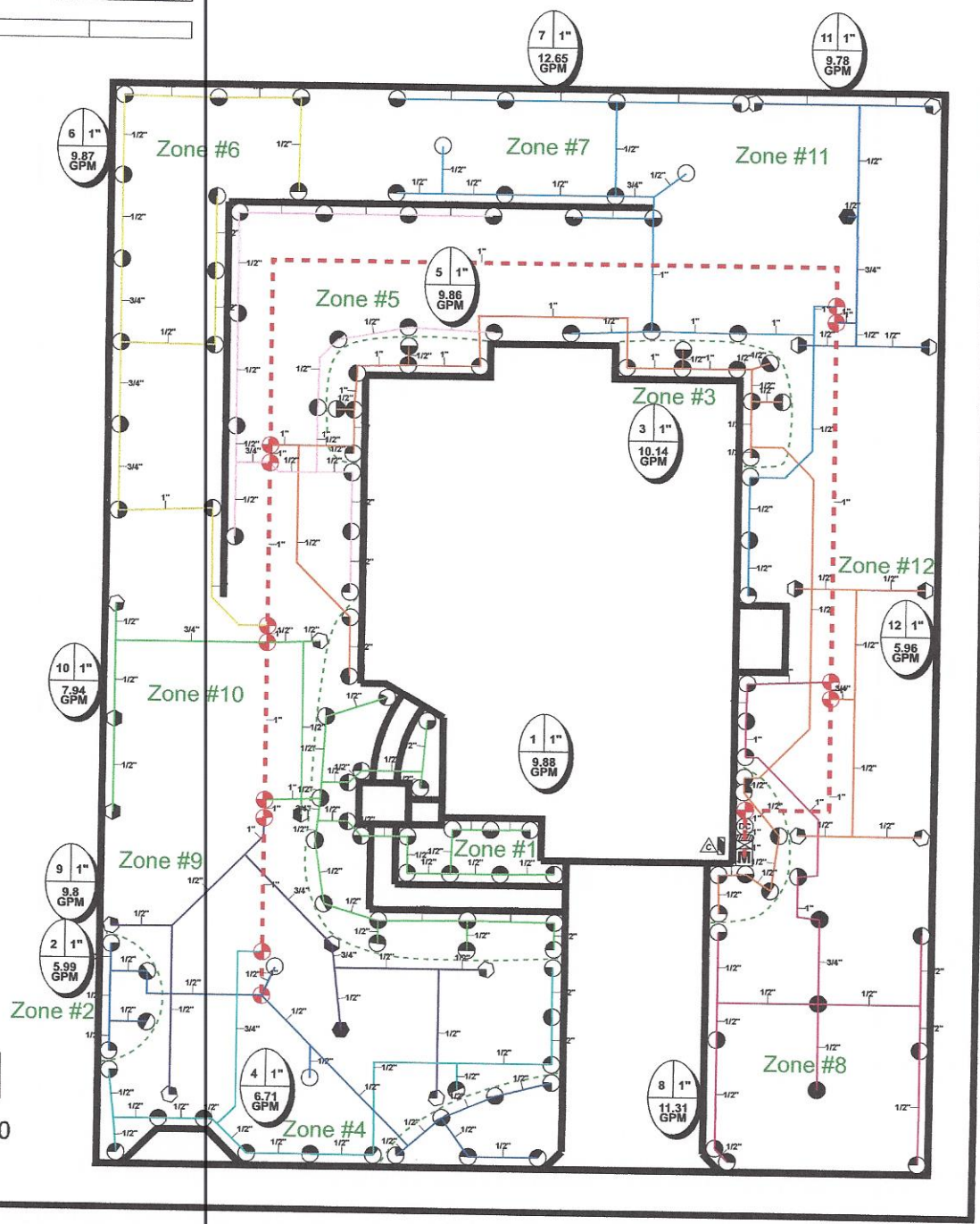
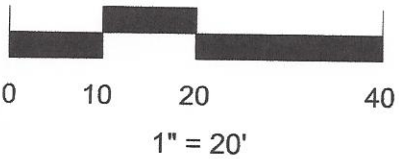

Best of Texas

Landscapes



PO BOX 776
HUTTO, TX 78634

(512)228-4833
(512)852-9633 fax

| Zone # | Description | Head Type | Run Time(Minutes) |
|--------|-------------|-------------------|-------------------|
| 1,3 | beds | Sprays | 15 |
| 2 | beds | Sprays + Bubblers | 15 |
| 4-6,8 | Turf | Sprays | 25 |
| 7 | Turf | Sprays + Bubblers | 25 |
| 9-12 | Turf | Rotors | 45 |
| | | | |
| | | | |
| | | | |
| | | | |

| Month | Average Cycles |
|-------|----------------|
| Jan. | 3 |
| Feb. | 3 |
| March | 4 |
| April | 4 |
| May | 7 |
| June | 9 |
| July | 11 |
| Aug. | 11 |
| Sept. | 9 |
| Oct. | 6 |
| Nov. | 4 |
| Dec. | 3 |

MAINTENANCE ITEMS

- Backflow device – Test Annually (Call Louis Sinclair 563-8762)
- Y-strainer – Check annually for debris
- Heads – Run system monthly to check for leaks or broken nozzles
- Valve covers – Trim grass around cover to expose
- Controller – Check seasonally for correct run times
- Winter – Run system briefly every 2 weeks if system remains in off position